

# RUBBER ACCESSORIES

## REDUCERS

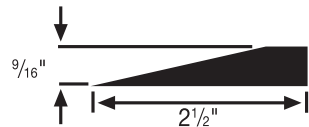
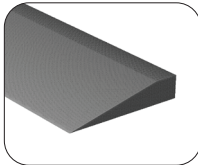
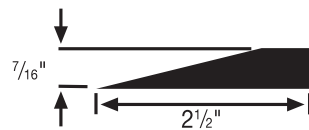
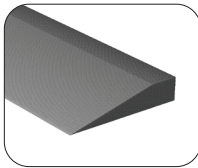

#20 & #49 transitional reducer  
7/16" (#20) 9/16" (#49)

- Choose 7/16" or 9/16" butting gauge;
- Minimum Installation Radius: 6 ft.
- 10 9-ft. secs. per tube (90 ft.)

ADA

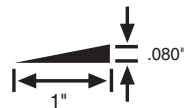
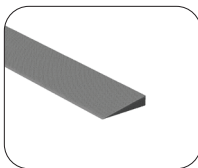

#21 reducer strip .080" for resilient floor

- Butt to reducer for .080" material; 1" beveled width for good transition
- Minimum Installation Radius: 6 ft.
- 16 9-ft. secs. per ctn. (144 ft.)

ADA

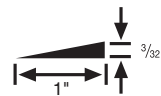
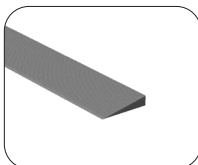
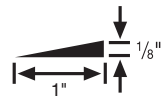
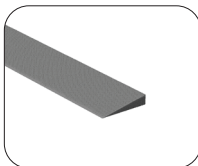

#22 & #48 reducer strip 1/8" (#22) 3/32" (#48)

- Same as #21 except choose 1/8" or 3/32" butting gauge
- Minimum Installation Radius: 6 ft.
- 16 9-ft. secs. per ctn. (144 ft.)

ADA

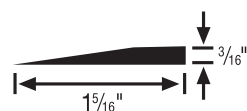
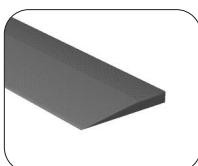

#23 reducer strip 3/16"

- 3/16" butting gauge; 1-5/16" width for smooth, neat transition
- Minimum Installation Radius: 6 ft.
- 16 9-ft. secs. per ctn. (144 ft.)

ADA

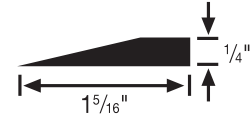
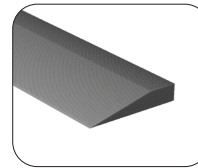

#24 reducer strip 1/4"

- Same as #23 except 1/4" butting gauge
- Minimum Installation Radius: 4 ft.
- 16 9-ft. secs. per ctn. (144 ft.)

ADA

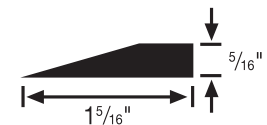
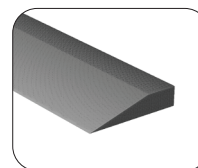

#25 reducer strip 5/16"

- Same as #23 except 5/16" butting gauge
- Minimum Installation Radius: 2 ft.
- 16 9-ft. secs. per ctn. (144 ft.)

ADA

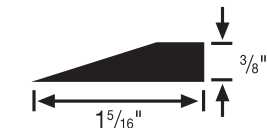
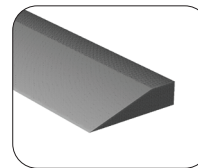

#26 reducer strip 3/8"

- Same as #23 except 3/8" butting gauge
- Minimum Installation Radius: 2 ft.
- 16 9-ft. secs. per ctn. (144 ft.)

ADA

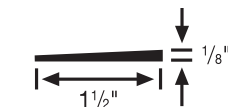
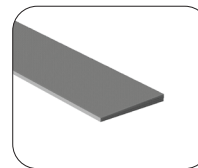

#45 reducer strip 1/8"

- 1/8" butting gauge; 1-1/2" width for smooth transition
- Minimum Installation Radius: 8 ft.
- 16 9-ft. secs. per ctn. (144 ft.)

ADA

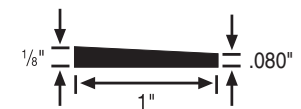
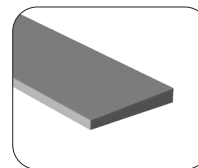

#59 reducer strip 1/8" tapering to .080"

- Special design for installations where a 1/8" must meet an .080" floor
- Minimum Installation Radius: 4 ft.
- 16 9-ft. secs. per ctn. (144 ft.)

ADA