

VINYL ACCESSORIES

ADAPTERS / TRANSITIONS

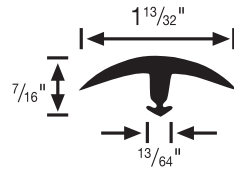
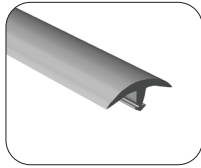

#152 snap-down divider

- 1-13/32" wide removable section for joining carpets
- Minimum Installation Radius: 6 ft.
- 20 12-ft. secs. per ctn. (240 ft.)

ADA

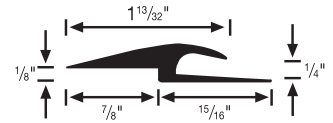
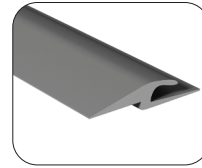

#177 tile carpet joiner

- Joins 1/4" carpet to 1/8" tile
- Minimum Installation Radius: 10 ft.
- 5 12-ft. secs. per ctn. (60 ft.)

ADA

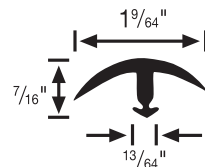
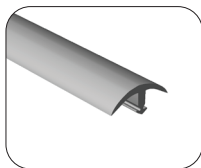

#154 snap-down edging

- 1-9/64" wide removable section for joining carpet to tile
- Minimum Installation Radius: 6 ft.
- 20 12-ft. secs. per ctn. (240 ft.)

ADA

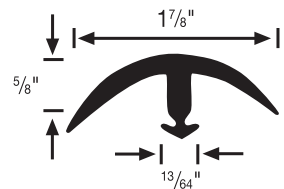
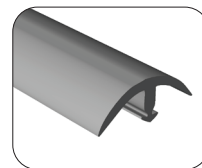

#179 snap-down super edge

- 1-7/8" wide removable section for joining carpet to wood/ceramic
- Minimum Installation Radius: 6 ft.
- 5 12-ft. secs. per ctn. (60 ft.)

ADA

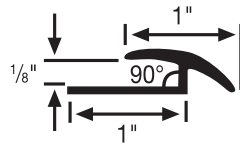
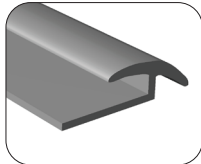

#159 tile carpet joiner

- Provides smooth carpet/ tile transition
- Minimum Installation Radius: 10 ft.
- 20 12-ft. secs. per tube (240 ft.)

ADA

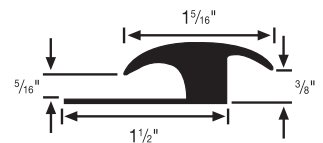
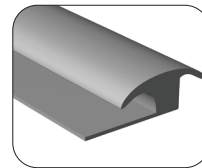

#182 ceramic/wood carpet transition 3/8"

- Molding for joining 5/16" carpet to 3/8" ceramic/wood flooring
- Minimum Installation Radius: 12 ft.
- 10 12-ft. secs. per tube (120 ft.)

ADA

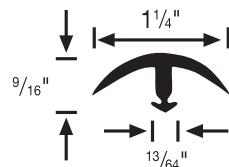
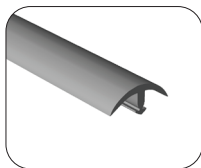

#175 snap-down edging

- 1-1/4" wide removable section for joining tile to wood
- Minimum Installation Radius: 6 ft.
- 20 12-ft. secs. per ctn. (240 ft.)

ADA

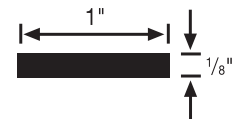
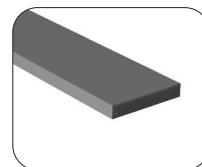

#195 feature strip

- Designed to transition between 1/8" tiles or add interest to floor design
- Minimum Installation Radius: 3 ft.
- 50 3-ft. pcs. per ctn. (150 ft.)

ADA